



FARONICS DEEP FREEZE™

Technical Data Sheet

About Deep Freeze

Deep Freeze preserves your computer configuration. Any changes - either malicious or unintentional- are reversed on reboot. This concept is called Reboot-to-Restore, where each reboot restores the computer to its desired configuration. The desired configuration is controlled by an IT administrator and the IT administrator has the ability to change the desired state.

How Deep Freeze Works

When Deep Freeze is in a *Frozen* state, any changes made to the computer are reversed on a reboot each time. When Deep Freeze is in a *Thawed* state, changes made to the computer, such as installing a new program or system updates are retained even after a reboot. Deep Freeze must be in a *Frozen* state for it to be protected. Deep Freeze uses patented technology (US Patent #7,539,828). Technically, this is how Deep Freeze works - Deep Freeze redirects information being written to the hard drive or partition to an allocation table, leaving the original data intact. The redirected information on the allocation table is no longer referenced once the computer is restarted, therefore restoring the computer back to its original state at the disk sector level down to the last byte.

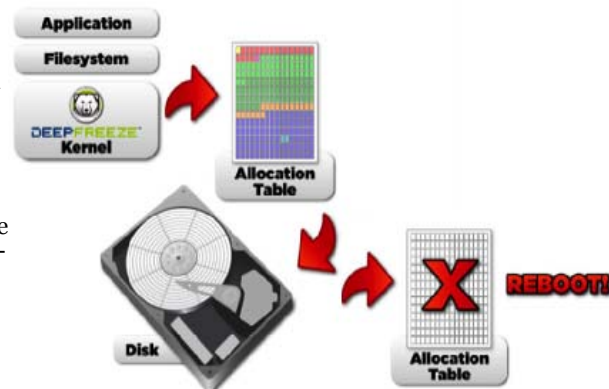

Customized Configuration

Configuration such as setting the Deep Freeze passwords, selecting drives to be Frozen, creating ThawSpaces, setting the behavior for external hard drives, creating embedded events, scheduling maintenance and setting advanced network options can be done by the Deep Freeze Configuration Administrator. Multiple customized installers with different configurations can be created based on the requirement. The Workstation Install files are then deployed on to the workstations to control Deep Freeze actions.

Control over Managing Workstations

The Deep Freeze Enterprise Console (part of the Deep Freeze Enterprise/Server Enterprise) allows the IT administrator to manage Deep Freeze on workstations over the network. IT administrators can Reboot Frozen, Reboot Thawed, deploy configuration remotely, lock keyboard and mouse, and perform many administrative tasks like scheduled maintenance on the workstations. Administrators can also manage Windows Updates and run their own batch files.

Multiple Security Features

Deep Freeze administrators must choose a unique ID called the Customization Code that encrypts all communication between Deep Freeze components (Configuration Administrator, Enterprise Console, and Command Line). The Customization Code ensures that unauthorized administrators are prevented from accessing or controlling a computer that runs Deep Freeze. Multiple Deep Freeze administrators controlling the same group of computers must use a matching Customization Code. IT administrators can also assign up to 15 passwords or create One-Time passwords that will expire after a single use on the workstation.

Retaining User Data

Users usually need to create and store their data on the computer. User data can be retained on a non-system drive or a virtual drive called a ThawSpace. Data retained in a ThawSpace or a Thawed drive is not erased on reboot even when the computer is in a Frozen state. You can also use Faronics Data Igloo (a free program) to redirect user profiles, folders with user data and registry keys to a Thawed drive.

Advanced Deployment Options

Installing the Deep Freeze Workstation Seed enables Deep Freeze Enterprise Console to communicate with the workstations where Deep Freeze Workstation Install file needs to be installed. In addition to deploying the Deep Freeze Workstation Install file via the Deep Freeze Enterprise Console, it can also be deployed as a Silent Install for rapid network deployment. Deep Freeze can also be deployed as part of a master image.

Flexible Network Architecture

Deep Freeze Enterprise/Server Enterprise can be deployed on multiple subnets and can also be managed from multiple locations by creating multiple Enterprise Consoles. Customized Enterprise Consoles (with select features and options) can be created and distributed to multiple administrators in your organization who manage different locations/subnets for enhanced security.

Compatibility with Third Party Management Tools

Deep Freeze Enterprise/Server Enterprise provides the Deep Freeze Command Line Control utility that can be used for Remote Management with various third party management tools.

The following section lists the features and system requirements for the various flavors of Deep Freeze.

Deep Freeze Feature Matrix

Feature	Standard	Enterprise	Server Standard	Server Enterprise	Mac
Protection					
Reboot Thawed and Reboot Frozen	•	•	•	•	•
Guarantees 100% workstation recovery on restart	•	•	•	•	•
Provides password protection and complete security	•	•	•	•	•
Protects Master Boot Record (MBR)	•	•	•	•	
Protects multiple hard drives and partitions	•	•	•	•	•
Integration and Compatibility					
Supports multi-boot environments	•	•	•	•	•
Compatible with Fast User Switching	•	•	•	•	•
Supports SCSI, ATA, SATA, and IDE hard drives	•	•	•	•	•
Single install for Windows XP, Vista and Windows 7	•	•			
Supports FAT, FAT32, NTFS, basic and dynamic disks	•	•	•	•	
Supports HFS and HFS+ format					•
Configuration Options					
Create customized installation files		•		•	•
Pre-select Frozen Drives and selectively Freeze or Thaw fixed drives	•	•	•	•	•
Schedule automatic Restart/Shutdown times		•		•	•
Restart the computer once the user logs off		•		•	
Shutdown workstations after a preset length of inactivity		•		•	
Schedule Thawed Maintenance periods to perform Windows Updates through the Internet or a SUS/WSUS server or run a custom batch file during maintenance		•		•	
Support for Apple updates					•
Set up to 15 passwords for using at the workstation or via the command line		•		•	
Central Management					
Schedule restart, shutdown, Wake-On-LAN, Freeze, Thaw and Thaw Locked tasks dynamically to take place once or on a regular basis		•		•	
Change maintenance and restart/shutdown schedules on the fly		•		•	•
Power-on workstations using Wake-On-LAN technology		•		•	
Use Workstation Seed for workstation communication and installation		•		•	
Manage workstations easily with User Defined Groups		•		•	
Quickly populate multiple groups or sub-groups with smart automatic filters or import groups from Active Directory		•		•	
Remotely deploy, execute, and control software on workstations		•		•	
Invoke system maintenance on demand with “Thaw Locked” mode		•		•	
Update all pre-existing installation files automatically		•		•	
Launch RDP and VNC sessions through the Enterprise Console		•		•	
Create Remote and Multiple Consoles with the Deep Freeze Server Service Manager		•		•	
Instantly send notification messages to workstations		•		•	
With Faronics Core, keep scheduled actions “active” to ensure updates on offline workstations		•		•	
With Faronics Core, manage workstations with dynamic groups, perform actions on workstation groups, view workstation activity status, and remotely wake-up offline workstations via the web		•		•	
Security and Control					
Encrypt all components with a unique Customization Code		•		•	
Preset multiple passwords to be used on a workstation or via the Command Line Control with varying activation and expiration dates		•		•	
Generate encrypted One Time or One Day Passwords		•		•	
Disable keyboard and mouse during maintenance periods or on demand		•		•	
Boot Control window provides ability for immediate reboot		•		•	
Use Stealth Mode to hide the Deep Freeze system tray icon		•		•	•

Feature	Standard	Enterprise	Server Standard	Server Enterprise	Mac
Data Retention					
Create ThawSpaces on a workstation that can be used to store programs, save files, or make permanent changes		•		•	•
ThawSpaces can be visible or hidden		•		•	
Specify the size and file system of the ThawSpace		•		•	•
Windows Updates		•		•	
Deployment Options					
Offers silent install option for rapid network deployment		•		•	
Provides option to deploy on multiple workstations as part of a master image	•	•	•	•	•
Communicate with workstations over a LAN, WAN, or combination		•		•	
Deep Freeze Command Line included in Workstation Installations		•		•	•
Support for multiple ports for use with Server Service Manager		•		•	
Interoperability Options					
Use Deep Freeze Command Line Control Utility (DFC) for remote management		•		•	
Integrate Deep Freeze protection into any Desktop Management Solution capable of executing command line control (www.faronics.com/deep-freeze-integration)		•		•	•
Action Files					
Create XML-based Deep Freeze Action Files to interact with other programs via the Deep Freeze Console		•		•	
Administrators will be able to create, edit, download and share Action Files with other users through Faronics Labs		•		•	
Antivirus Integration					
Malware definitions for other anti-virus solutions can be easily retained through use of Thawed Maintenance periods		•		•	
Seamless malware definitions on workstations protected in a Frozen state with Faronics Anti-Virus		•		•	
System Requirements					
Windows XP, Vista, Windows 7, Windows 8.1, Windows 10 (32 and 64 Bit)	•	•			
Windows Server 2000, 2003, 2008, 2012			•	•	
10.7 (Lion), 10.8 (Mountain Lion), 10.9 Mavericks, 10.10 (Yosemite), 10.11 (El Capitan), 10.12 (Sierra)					•



About Faronics

Faronics delivers market-leading solutions that help manage, simplify, and secure complex IT environments. Our products ensure 100% machine availability, and have dramatically impacted the day-to-day lives of thousands of information technology professionals. Fueled by a market-centric focus, Faronics' technology innovations benefit educational institutions, health care facilities, libraries, government organizations, and corporations.

Contact Faronics

Vancouver (Head Office)	USA	Europe
609 Granville Street, Suite 1400, P.O. Box 10362 Vancouver, BC, V7Y 1G5 Canada Call Toll Free: 1-800-943-6422 Call Local: 1-604-637-3333	5506, Sunol Blvd, Suite 202 Pleasanton, CA, 94566 Call Toll Free: 1-800-943-6422	8 The Courtyard, Eastern Road, Bracknell, Berkshire, RG12 2XB, United Kingdom Call Local: +44 (0) 1344 206 414
Web: www.faronics.com		